

FILTER REGULATOR - LUBRICATOR UNIT

TYPE GPA



TECHNICAL CHARACTERISTICS

Filter element :	40 μm
Medium :	compressed air
Size of sprayed oil particles :	max. 4 μm
Number of drops / minute :	20 ... 120
Upstream pressure :	max. 10 bar
Working pressure range:	0 ... 6 bar
Pressure in sprayer :	1,5 ... 3,5 bar
Standard nominal flow rate :	550 l/min for ND 6 1180 l/min for ND 10 1480 l/min for ND 16
Pressure switch operating range:	1.5 to 3.5bar

Electrical rating of switch : 220 VAC / 5A
Oil type : L 10 or equivalent

Operating temperature range : -5...+50°C
Mounting position : vertically $\pm 5^\circ$
Mounting : mounting bracket or front panel mounting

Material :
- housing : aluminium alloy
- filter and lubricator bowl : polycarbonate
- seals : rubber B14type

OVERALL AND MOUNTING DIMENSIONS

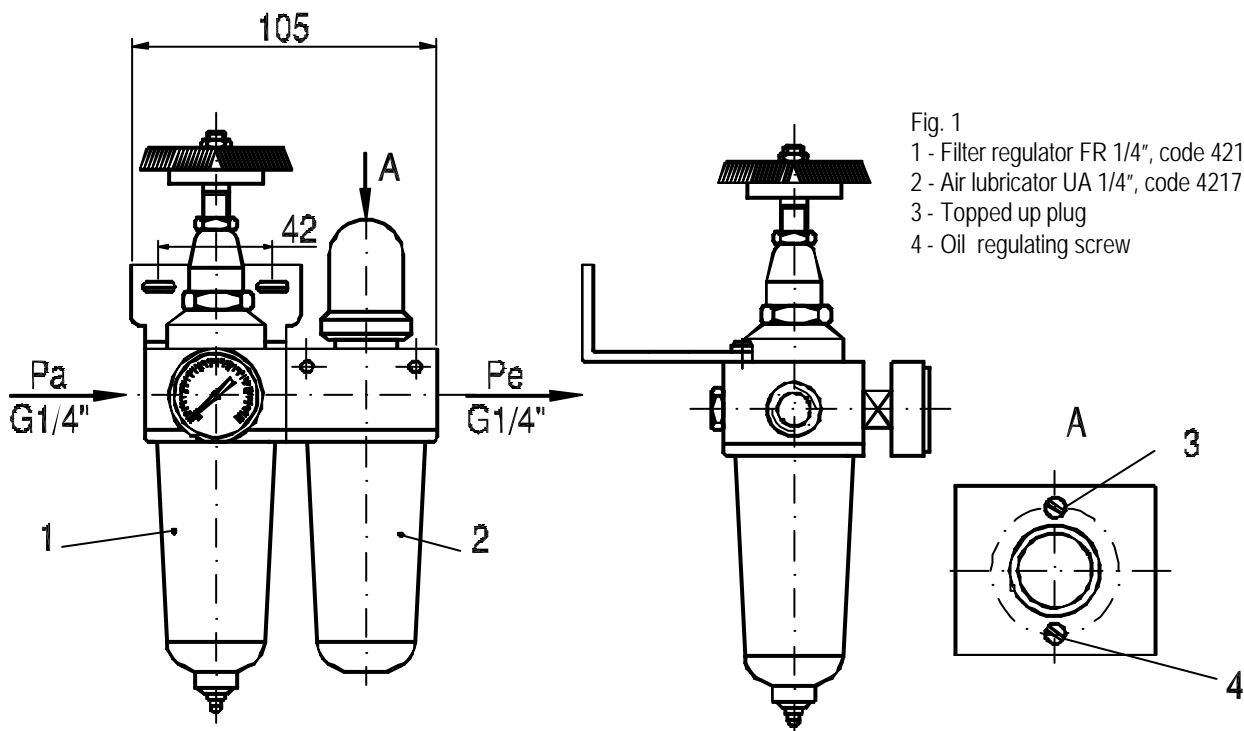

Fig. 1
1 - Filter regulator FR 1/4", code 4217.1331
2 - Air lubricator UA 1/4", code 4217.1332
3 - Topped up plug
4 - Oil regulating screw

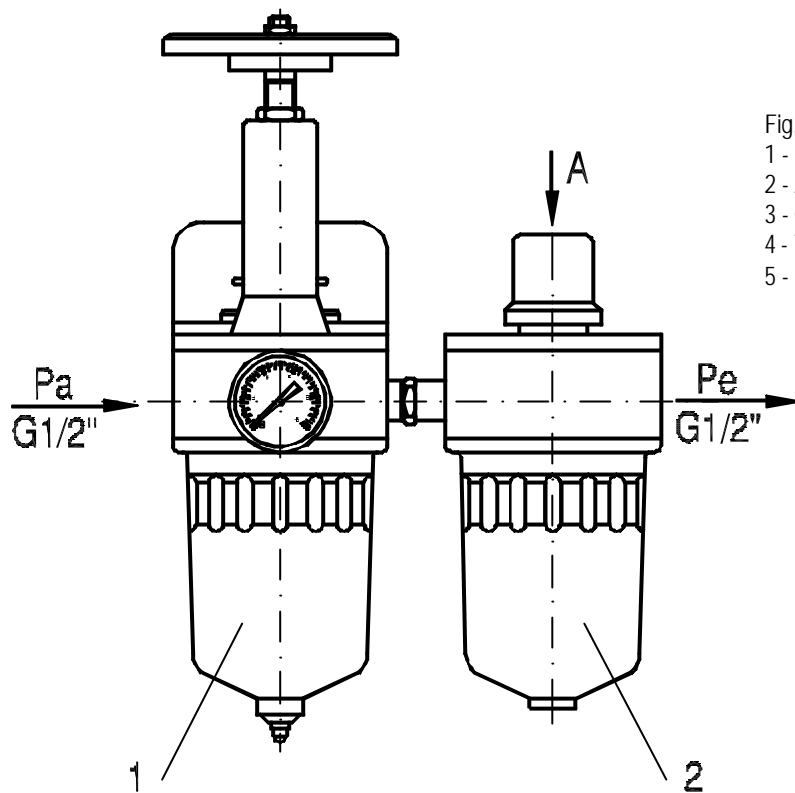

Fig. 2
 1 - Filter regulator FR 1/2", code 4217.1333
 2 - Air lubricator UA 1/2", code 4217.1334
 3 - Oil regulating screw
 4 - Topped up plug
 5 - Flow control valve

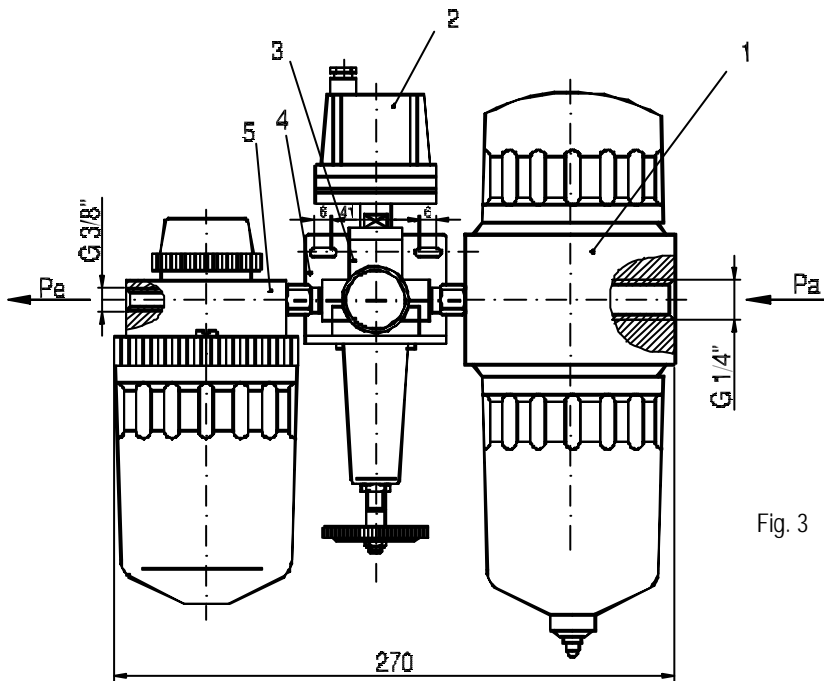

Fig. 3

- 1 - Filter regulator FA 1/4", code 4217.1335
- 2 - Pressure reducer RP1 - for 0 at level d, code 4217.1336
 RP2 - for 1at level d, code 4217.1337
- 3 - Pressure switch, PME4 type
- 4 - Mounting bracket
- 5 - Sprayer code 4217.1338 ... PUM 2.01. (without electric signaling of oil level) - L=330 mm
 code 4217.1339 ... PUM 2.02. (with electric signaling of oil level) - L=330 mm
 cod. 4217.1340 ... PUM 3.01. (without electric signaling of oil level) - L=300 mm
 cod. 4217.1341 ... PUM 3.02. (with electric signaling of oil level) - L=300 mm

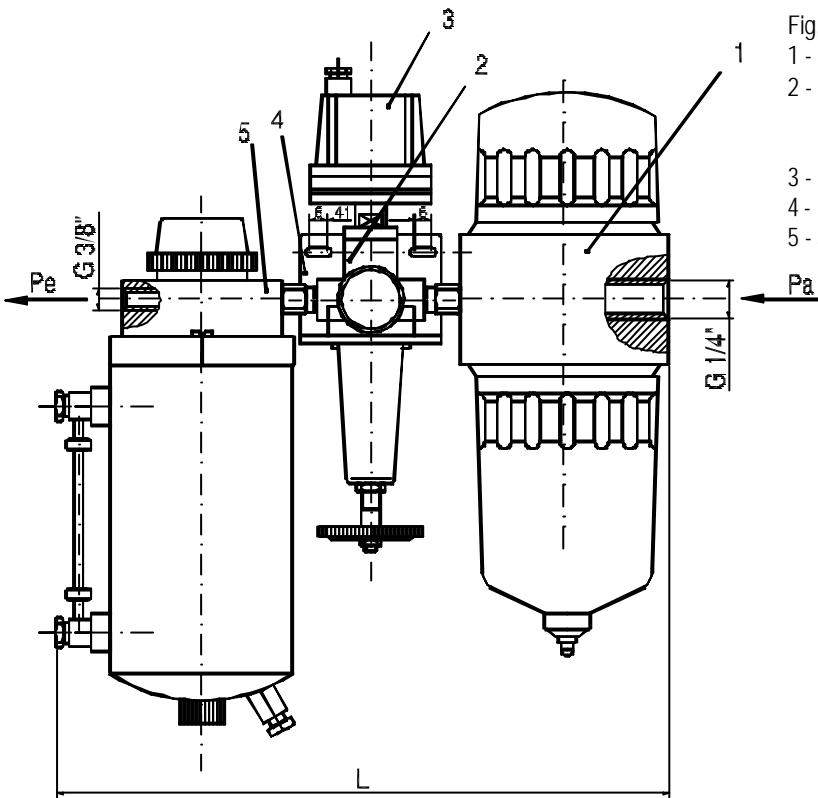

Fig. 4

1 - Filter regulator FA 1/4", code 4217.1335

2 - Pressure reducer (see coding):

RP1 for 0 at level d, code 4217.1336

RP2 for 1 at level d, code 4217.1337

3 - Pressure switch (see coding) : PME4 for 02 at level d

4 - Mounting bracket

5 - Sprayer PUM 4; code 4217.1342

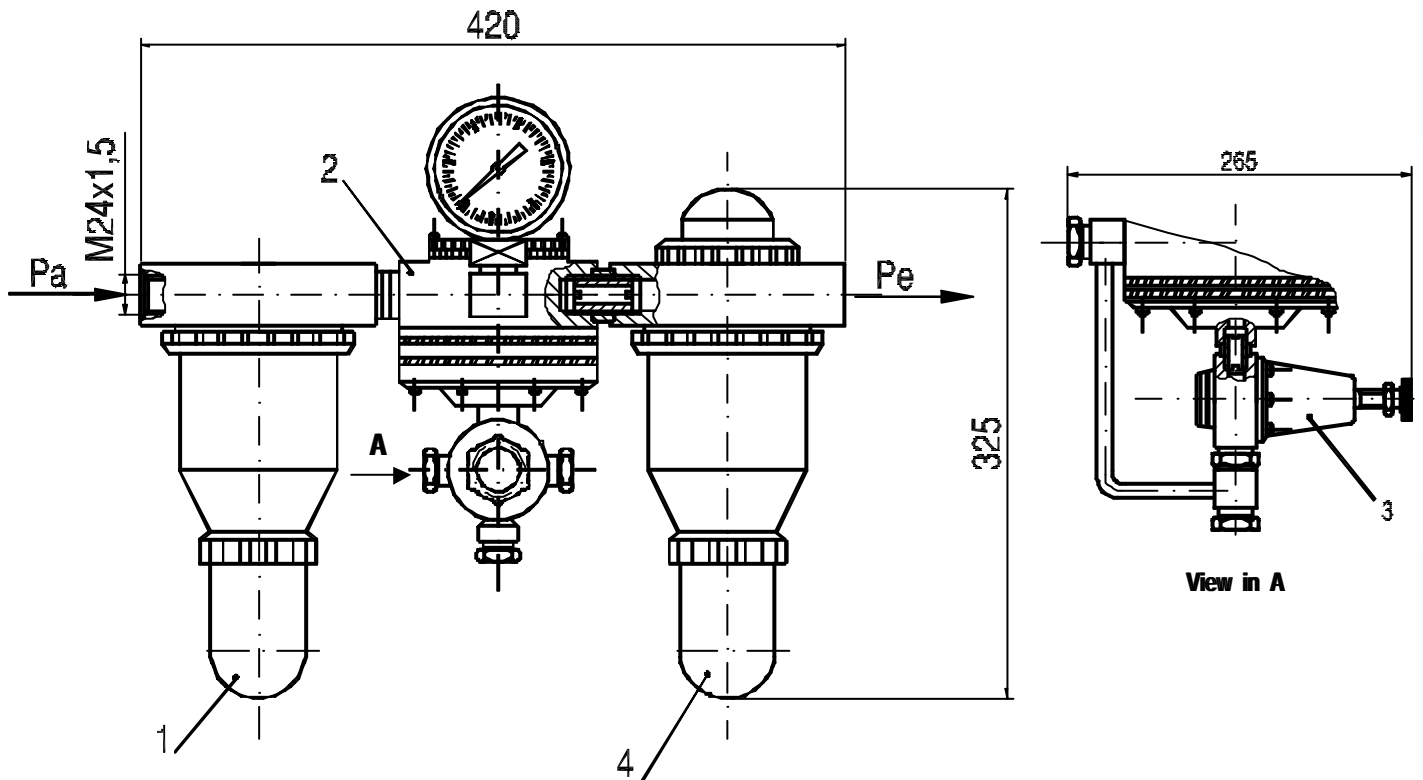

Fig.5

1 - Air filter

2 - Main pressure reducer

3 - Pilot pressure reducer

4 - Lubricator

CODING (HOW TO ORDER)

GPA	X	X	X	X	Coding level denomination
Coding Level	a	b	c	d	
					a. Scope of delivery
1					Input / Output connectors type G 1/4"; nominal size (ND) 6 mm (see fig. 1)
2					Input / Output connectors type G 1/2"; nominal size (ND) 10 mm (see fig. 2)
3					Input connector type G 1/4", Output connector G 3/8"; nominal size (ND) 6 mm; with sprayer (see fig. 3 and fig. 4)
4					Input / Output connectors type M24x1,5; Nominal size ND =16 mm; (fig.5).
					b. Type of lubricator
0					Without sprayer, with lubricator (fig. 1 ; fig. 2 and fig. 5)
1					With sprayer and lubricator – oil capacity 2l (fig. 3)
2					With sprayer and lubricator – oil capacity 1l (fig.3)
3					With sprayer and lubricator – oil capacity 0,25 l (fig.4)
					c. Oil level signaling
0					Without electrical signaling of oil level in sprayer
1					With electrical signaling of oil level in sprayer (coded only with 1 and 2 at level b)
					d. Air disconnection signaling
0					Without pressure switch
1					With pressure switch (only with 1 and 2 at level b)

NOTE: Filter regulator (FR), air filter (FA), pressure reducing (RP), air lubricator (UA) and sprayer (PUM) can be delivery separately at beneficiary command